

(2)



OFFICIAL RECORDS OF
PINAL COUNTY RECORDER
LAURA DEAN-LYTTLE

DATE: 02/16/00 TIME: 1423
FEE : 18.00
PAGES: 2
FEE NO: 2000-007075

When recorded mail to :

DE M ENGINEERING
1783 W UNIVERSITY Ste 136
TEMPE AZ 85281

(The above space reserved for recording information)

CAPTION HEADING

AFFIDAVIT OF CORRECTION

Fee # 2000-003436

DO NOT DISCARD THIS PAGE. THIS COVER PAGE IS RECORDED AS PART OF YOUR DOCUMENT. THE CERTIFICATE OF RECORDATION WITH THE FEE NUMBER IN THE UPPER RIGHT CORNER IS THE PERMANENT REFERENCE NUMBER OF THIS DOCUMENT IN THE PINAL COUNTY RECORDER'S OFFICE.

AFFIDAVIT OF CORRECTION

Plat of Lost Dutchman Gardens

The NE ¼, NW ¼, NW1/4, Section 18, Township 1 North, Range 8 East of the G. & S.R.B,
Pinal County Arizona

We hereby certify that we are the surveyors who prepared the final plat for the subdivision named "Lost Dutchman Gardens", in Pinal County, Arizona, recorded in Cabinet C, Slide 115, on January 24, 2000 in the Records of Pinal County, Arizona and the following errors on the plat need to be corrected:

1. Sheet 1 of 2. Under SITE AREAS TRACT "A" in parenthesis after INTERIOR STREETS = 1.5973 ACRES is to be deleted and TRACT "B" in parenthesis after OPEN SPACE = 0.4628 ACRES is to be changed to TRACT "A".
2. Sheet 2 Of 2. TRACT "B" should be TRACT "A".

Dean R. Crouse

Dean R. Crouse, R.L.S.

D&M Engineering

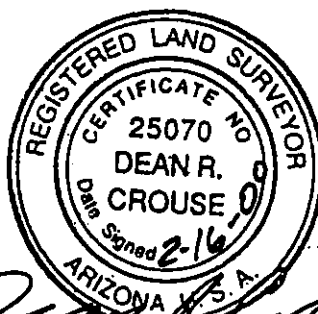

Dean R. Crouse

LEGAL DESCRIPTION

PARCEL NO. 1

LOT 4 ACCORDING TO C.S. 0007, SITE SUBDIVISION PLAN 9 C-302 AS

EXCEPT THE NORTH 30 FEET AND THE EAST 30 FEET BOUNDARY AND

COMMENSAL AS THE NORTHEAST CORNER OF THE NORTHEAST

QUARTER OF THE NORTHEAST QUARTER OF SECTION 13

THENCE WEST ALONG THE NORTH LINE OF SECTION 13 A DISTANCE OF

THENCE WEST ALONG A LINE PARALLEL TO AND 30 FEET DISTANT TO

THENCE EAST ALONG A LINE PARALLEL TO AND 30 FEET DISTANT TO

THENCE SOUTH ALONG A LINE PARALLEL TO AND 30 FEET DISTANT TO

THENCE PROCEEDING IN A NORTHWESTLY DIRECTION TO THE TRUE

EXCEPT ALL OIL, GAS AND OTHER MINERAL RIGHTS AS RESERVED IN

PARCEL NO. 2

LOT 4 ACCORDING TO C.S. 0007, SITE SUBDIVISION PLAN 9 C-302 AS

EXCEPT THE NORTH 30 FEET AND THE EAST 30 FEET BOUNDARY AND

COMMENSAL AS THE NORTHEAST CORNER OF THE NORTHEAST

QUARTER OF THE NORTHEAST QUARTER OF SECTION 13

THENCE WEST ALONG THE NORTH LINE OF SECTION 13 A DISTANCE OF

THENCE WEST ALONG A LINE PARALLEL TO AND 30 FEET DISTANT TO

THENCE EAST ALONG A LINE PARALLEL TO AND 30 FEET DISTANT TO

THENCE SOUTH ALONG A LINE PARALLEL TO AND 30 FEET DISTANT TO

THENCE PROCEEDING IN A NORTHWESTLY DIRECTION TO THE TRUE

EXCEPT ALL OIL, GAS AND OTHER MINERAL RIGHTS AS RESERVED IN

PARCEL NO. 3

LOT 4 ACCORDING TO C.S. 0007, SITE SUBDIVISION PLAN 9 C-302 AS

EXCEPT THE NORTH 30 FEET AND THE EAST 30 FEET BOUNDARY AND

COMMENSAL AS THE NORTHEAST CORNER OF THE NORTHEAST

QUARTER OF THE NORTHEAST QUARTER OF SECTION 13

THENCE WEST ALONG THE NORTH LINE OF SECTION 13 A DISTANCE OF

THENCE WEST ALONG A LINE PARALLEL TO AND 30 FEET DISTANT TO

THENCE EAST ALONG A LINE PARALLEL TO AND 30 FEET DISTANT TO

THENCE SOUTH ALONG A LINE PARALLEL TO AND 30 FEET DISTANT TO

THENCE PROCEEDING IN A NORTHWESTLY DIRECTION TO THE TRUE

EXCEPT ALL OIL, GAS AND OTHER MINERAL RIGHTS AS RESERVED IN

PARCEL NO. 4

LOT 4 ACCORDING TO C.S. 0007, SITE SUBDIVISION PLAN 9 C-302 AS

EXCEPT THE NORTH 30 FEET AND THE EAST 30 FEET BOUNDARY AND

COMMENSAL AS THE NORTHEAST CORNER OF THE NORTHEAST

QUARTER OF THE NORTHEAST QUARTER OF SECTION 13

THENCE WEST ALONG THE NORTH LINE OF SECTION 13 A DISTANCE OF

THENCE WEST ALONG A LINE PARALLEL TO AND 30 FEET DISTANT TO

THENCE EAST ALONG A LINE PARALLEL TO AND 30 FEET DISTANT TO

THENCE SOUTH ALONG A LINE PARALLEL TO AND 30 FEET DISTANT TO

THENCE PROCEEDING IN A NORTHWESTLY DIRECTION TO THE TRUE

EXCEPT ALL OIL, GAS AND OTHER MINERAL RIGHTS AS RESERVED IN

PARCEL NO. 5

LOT 4 ACCORDING TO C.S. 0007, SITE SUBDIVISION PLAN 9 C-302 AS

EXCEPT THE NORTH 30 FEET AND THE EAST 30 FEET BOUNDARY AND

COMMENSAL AS THE NORTHEAST CORNER OF THE NORTHEAST

QUARTER OF THE NORTHEAST QUARTER OF SECTION 13

THENCE WEST ALONG THE NORTH LINE OF SECTION 13 A DISTANCE OF

THENCE WEST ALONG A LINE PARALLEL TO AND 30 FEET DISTANT TO

THENCE EAST ALONG A LINE PARALLEL TO AND 30 FEET DISTANT TO

THENCE SOUTH ALONG A LINE PARALLEL TO AND 30 FEET DISTANT TO

THENCE PROCEEDING IN A NORTHWESTLY DIRECTION TO THE TRUE

FINAL PLAT

FOR

LOST DUTCHMAN GARDENS

A CR-3 SINGLE FAMILY RESIDENTIAL DEVELOPMENT SITUATED IN THE NE 1/4, NW 1/4, NW 1/4, SECTION 13, T-1-N, R-8-E OF THE GILA AND SALT RIVER BASE AND MERIDIAN, PINAL COUNTY, ARIZONA.

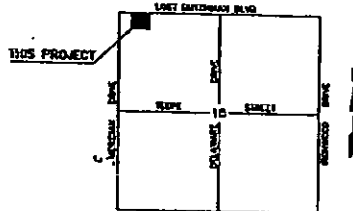

VICINITY MAP

UTILITIES AND SERVICES

- WATER - ARIZONA WATER CO.
SEWER - SUPERSTITION MOUNTAINS COMMUNITY DISTRICT
ELECTRIC - SALT RIVER PROJECT
GAS - SANMOUNT GAS CORPORATION
TELEPHONE - US WEST COMMUNICATIONS
REFUSE - PRIVATE
SCHOOLS - APACHE JUNCTION SCHOOL DISTRICT
POLICE - CITY OF APACHE JUNCTION
FIRE - APACHE JUNCTION FIRE DISTRICT

SITE AREAS

- NET AREA - 3.622 ACRES
DROVE AREA - 0.285 ACRES
WINDSOR STRIP - 0.1875 ACRES (TRACT "A")
OVER SPACE - 0.159 ACRES (TRACT "B")

SHEET INDEX

- SHEET 1 COVER SHEET
SHEET 2 FINAL PLAT

BASIS OF BEARINGS

THE BASIS OF BEARINGS FOR THIS SURVEY IS THE NORTH LINE OF SECTION 13... BEARING IS EAST, AS INDICATED BY THE POINTS... CAPS AT THE NORTHEAST CORNER AND NORTH 1/4 CORNER...

CERTIFICATE OF SURVEY

I, JOHN R. CHAPPEL, MERRY CERTIFY THAT I AM A REGISTERED LAND SURVEYOR IN THE STATE OF ARIZONA... AND COMPLETE AS SHOWN THAT THE INSTRUMENT SHOWS ACTUALLY EXIST AS SHOWN ON THIS PLAT... SET WITHIN ONE (1) YEAR...

John R. Chappel, Surveyor, State of Arizona, License No. 11111, dated 11-1-99.

DEDICATION

STATE OF ARIZONA COUNTY OF PINAL... I HEREBY DEDICATE TO THE PUBLIC THE PUBLIC RIGHT OF WAY SHOWN AND DESCRIBED HEREIN... FOR THE PURPOSES SHOWN.

FOR: ALC BUILDERS, INC. BY: [Signature] DATE: Dec. 1999. PRESIDENT: [Signature]

ACKNOWLEDGMENT

STATE OF ARIZONA COUNTY OF MARICOPA... ON THIS 12th DAY OF Dec., 1999, BEFORE ME, THE UNDERSIGNED NOTARY PUBLIC, APPEARED ARLEN L. GALL, who acknowledged himself to be the president of ALC BUILDERS, INC....

OWNER AGREEMENT

IT IS AGREED THAT ALL LOTS WILL BE SEPARATELY TITLED AND MAPPED AS DESCRIBED ON THE FINAL PLAT... BY: [Signature] PRESIDENT ALC BUILDERS, INC.

ACKNOWLEDGMENT

STATE OF ARIZONA COUNTY OF MARICOPA... ON THIS 12th DAY OF Dec., 1999, BEFORE ME, THE UNDERSIGNED NOTARY PUBLIC, APPEARED ARLEN L. GALL, who acknowledged himself to be the secretary/treasurer of ALC BUILDERS, INC....

APPROVALS

CITY ENGINEER'S CERTIFICATE... THIS FINAL PLAT HAS BEEN CHECKED FOR CONFORMANCE WITH CITY OF APACHE JUNCTION ORDINANCE... BY: [Signature] DATE: 12/1/99

APPROVED BY THE CITY COUNCIL OF THE CITY OF APACHE JUNCTION, ARIZONA... BY: [Signature] DATE: 11-1-99

Vertical strip on the right side containing contact information for D & M Engineering, Inc. and the project name 'LOST DUTCHMAN GARDENS'.

NOTES

1. THIS SUBDIVISION IS LOCATED WITHIN THE ARIZONA WELLS COMPANY WELLS SERVICE AREA AND HAS BEEN DESIGNATED AS HAVING AN ASSURED WATER SUPPLY.
2. NO UTILITIES NEW OR EXISTING ARE INDICATED TO BE PLACED UNDERGROUND.
3. UTILITIES A PARTIAL EASEMENT EXCEPT FURNISHING THE OWNER OR PLACED WITHIN THE PUBLIC BY CITY LANDSCAPE ARCHITECT. IT SHALL BE FURTHER UNDERSTOOD THAT THE CITY OF ANAPACHE RESERVES THE RIGHT TO BE RELIANT TO REPLACE ANY UNDERGROUND UTILITIES THAT MAY BE LOCATED WITHIN THE COURSE OF MAINTENANCE, CONSTRUCTION OR RECONSTRUCTION BY CITY.
4. STRUCTURES AND LANDSCAPING AT THE INTERSECTION OF PUBLIC STREETS, WITHIN A TRaversable BEARING 12° ± 12' ALONG THE STREET RIGHT-OF-WAY LINE, SHALL BE MAINTAINED AT A MINIMUM HEIGHT OF 7'.
5. THE 200 YEAR FLOOD AREA DESIGNATED AS "ZONE A" BY THE FEDERAL EMERGENCY MANAGEMENT AGENCY (FEMA) AS SHOWN ON FLOOD INSURANCE RATE MAP (FIRM) NUMBER 85098 C, DATED MARCH 19, 1988. "ZONE A" IS DESIGNATED AS "AREA OF 100-YEAR FLOOD AREAS OF 100-YEAR FLOOD WITH AVERAGE DEPTHS OF FEET THAT ONE FOOT OR MORE ORANGE AREAS LIES THAT ONE SQUARE MILE AND AREA PROTECTED BY LEVEE FROM 100-YEAR FLOOD".
6. ALL FINISHED FLOOR ELEVATIONS SHALL BE CHECKED, A MINIMUM OF 14" ABOVE OUTSIDE 1/4" GRADE OF GULLY.

CURVE TABLE

CURVE NO.	RADIUS	LENGTH	DELTA	CHORD	PERCENT
1	100.00	157.08	108.00	100.00	100.00
2	100.00	157.08	108.00	100.00	100.00
3	100.00	157.08	108.00	100.00	100.00
4	100.00	157.08	108.00	100.00	100.00
5	100.00	157.08	108.00	100.00	100.00
6	100.00	157.08	108.00	100.00 <td 100.00	

LEGEND

- A INDICATES CORNER OF THIS SUBDIVISION BY 1/4" MARK
- B INDICATES CORNER OF THIS SUBDIVISION FOUND BRASS CAP IN 1980 FILE
- C INDICATES SET BRASS CAP FOUND
- PLATE INDICATES PUBLIC UTILITIES & FACILITIES EASEMENT
- PLATE INDICATES RETAIL/WHOLESALE HIGH-ACCESS EASEMENT
- PLATE INDICATES BRUSHING STRIP EASEMENT
- PLATE INDICATES DRAINAGE EASEMENT
- SET 1/4" MARK & ALL LOT CORNERS UNLESS OTHERWISE NOTED

NOTE: 14" MIN. REQUIRED BETWEEN BUILDINGS DEVELOPING THIS OPENING TO MAINTAIN THE 5' OR 6' SIDE SETBACK REQUIREMENT TO EACH LOT.

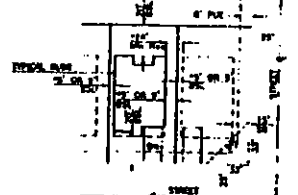

TYPICAL LOT SETBACKS

STATE OF ARIZONA
COUNTY OF PINAL # 24P2

Tract 24P2
Final Plat
2000 West Lost Dutchman Blvd
Anapache Junction, Pinal County, Arizona



D & M ENGINEERING
Daren Thompson, P.E.
1783 W. University Dr., Suite 136
Tempe, AZ 85281
PH: (602) 350-3350
FAX: (602) 350-1485



NO.	DATE	DESCRIPTION
1	10/15/00	PRELIMINARY
2	11/15/00	FINAL
3	12/15/00	AS BUILT



LOST DUTCHMAN GARDENS
FINAL PLAT
2000 WEST LOST DUTCHMAN BLVD
ANAPACHE JUNCTION, PINAL COUNTY, ARIZONA

2000
9/15/00

