

# FINAL PLAT FOR "PASEO LAS COLINAS"

PASEO LAS COLINAS HOME OWNERS ASSOCIATION DRAINAGE MAINTENANCE RESPONSIBILITY  
 ALL DRAINAGE INFRASTRUCTURE SHOWN ON THE FINAL CONSTRUCTION DOCUMENTS FOR  
 PASEO LAS COLINAS SUBDIVISION, WHETHER IT IS LOCATED IN DRAINAGE EASEMENTS,  
 ROADWAY EASEMENTS, TRACTS OR ON PRIVATE LOTS, SHALL BE MAINTAINED BY THE  
 PASEO LAS COLINAS HOME OWNERS ASSOCIATION.

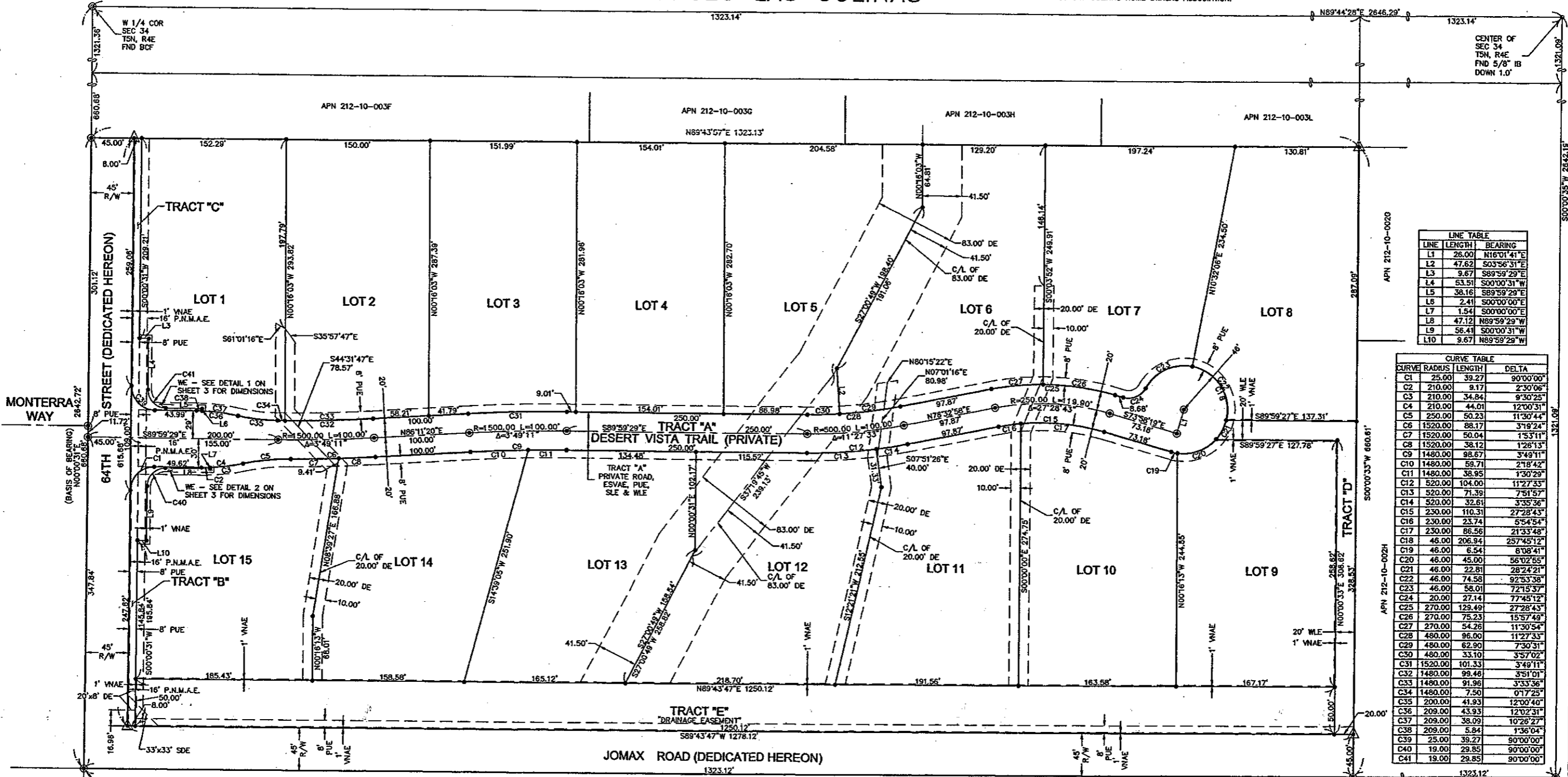

LINE TABLE		
LINE	LENGTH	BEARING
L1	26.00	N16°01'41"E
L2	47.62	S03°56'31"E
L3	9.67	S89°59'29"E
L4	63.51	S00°00'31"W
L5	38.16	S89°59'29"E
L6	2.41	S00°00'00"E
L7	1.54	S00°00'00"E
L8	47.12	N89°59'29"W
L9	56.41	S00°00'31"W
L10	9.67	N89°59'29"W

CURVE TABLE			
CURVE	RADIUS	LENGTH	DELTA
C1	25.00	39.27	90°00'00"
C2	210.00	9.17	2°30'06"
C3	210.00	34.84	9°30'25"
C4	210.00	44.01	12°00'31"
C5	250.00	50.23	11°30'44"
C6	1520.00	88.17	3°19'24"
C7	1520.00	50.04	1°53'11"
C8	1520.00	38.12	1°28'13"
C9	1480.00	98.67	3°49'11"
C10	1480.00	59.71	2°18'42"
C11	1480.00	38.95	1°30'29"
C12	520.00	104.00	11°27'33"
C13	520.00	71.39	7°51'57"
C14	520.00	32.61	3°35'36"
C15	230.00	110.31	27°28'43"
C16	230.00	23.74	5°54'54"
C17	230.00	86.56	21°33'48"
C18	46.00	206.94	25°45'12"
C19	46.00	6.54	8°08'41"
C20	46.00	45.00	56°02'55"
C21	46.00	22.81	28°24'21"
C22	46.00	74.58	92°53'38"
C23	46.00	58.01	72°15'37"
C24	20.00	27.14	77°45'12"
C25	270.00	129.49	27°28'43"
C26	270.00	75.23	15°57'49"
C27	270.00	54.28	11°30'54"
C28	480.00	96.00	11°27'33"
C29	480.00	62.90	7°30'31"
C30	480.00	33.10	3°57'02"
C31	1520.00	101.33	3°49'11"
C32	1480.00	99.48	3°51'01"
C33	1480.00	91.96	3°33'36"
C34	1480.00	7.50	0°17'25"
C35	200.00	41.93	12°00'40"
C36	209.00	43.93	12°02'31"
C37	209.00	38.09	10°28'27"
C38	209.00	5.84	1°36'04"
C39	25.00	39.27	90°00'00"
C40	19.00	29.85	90°00'00"
C41	19.00	29.85	90°00'00"

**LEGEND**

- SECTION LINE
- BOUNDARY LINE
- LOT LINES
- STREET CENTERLINE
- EASEMENT LINE (AS NOTED)
- NAOS EASEMENT LINE
- FLOODZONE
- FOUND BRASS CAP FLUSH
- STREET CENTERLINE SURVEY MONUMENT TO BE INSTALLED AS TYPE "B" PER MAG DET 120-1
- SET 1/2" REBAR W/CAP MARKED "RLS 17548" TO BE SET AT THE COMPLETION OF MASS GRADING
- SUBDIVISION CORNER, 1/2" REBAR W/CAP MARKED "RLS 17548", CORNER SET AS OF JAN. 2, 2008
- NAOS EASEMENT (SEE SHEET 3)

- C1 CURVE NUMBER - SEE CURVE TABLE
- DE DRAINAGE EASEMENT
- L1 LINE NUMBER - SEE LINE TABLE
- MC MARICOPA COUNTY
- MCR MARICOPA COUNTY RECORDS
- NAOS NATURAL AREA OPEN SPACE (SEE SHEET 3)
- P.N.M.A.E. PUBLIC NON-MOTORIZED ACCESS EASEMENT
- PUE PUBLIC UTILITY EASEMENT
- R/W RIGHT-OF-WAY TO BE DEDICATED WITH THIS PLAT
- SOE SIGHT DISTANCE EASEMENT
- SLE SEWER LINE EASEMENT
- VNAE VEHICULAR NON ACCESS EASEMENT
- WE WALL EASEMENT
- WLE WATER LINE EASEMENT

NOTE: SEE SHEET 3 FOR LOCATION OF NAOS EASEMENTS.

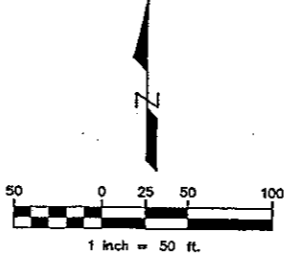

FINAL PLAT  
 FOR  
 "PASEO LAS COLINAS"

THE SOUTH HALF OF THE SOUTHWEST QUARTER OF THE SOUTHWEST QUARTER OF SECTIONS 34, TOWNSHIP 5 NORTH, RANGE 4 EAST OF THE GILA AND SALT RIVER MERIDIAN, MARICOPA COUNTY, ARIZONA.

DATE: 01-02-08  
 DRN BY: BES  
 CHKD BY: EFV  
 JOB NO. 062219  
 SHEET  
2  
 OF 3